

SAGOLA

an Elcometer company



PROFESSIONAL PAINTING EQUIPMENTS FOR INDUSTRY



www.sagola.com

MADE IN
SPAIN

X4100 SERIES

The industrial SAGOLA spraygun par excellence
With a new design
Smaller, compact and lightweight
Maximum robustness. Minimum maintenance

Ideal for painting large areas with extreme finishing in sectors such as automotive, industrial vehicles and all types of industrial machinery. Anodized forged aluminum body. With no joints to manipulate when disassembling for through cleaning of the paint part. High transfer aircaps HVLP and EPA.

VERSION GRAVITY X4100



VERSION	CODE	APPLICATION
1.30 [96]	10142012	Fluid finishes, metallics, dyes
1.40 [96]	10142001	High quality finishes
2.20 [64S]	10142011	High viscosity products
1.40 [XT01]	10142005	General finishes
1.40 [XT03]	10142008	General finishes. Minimum mist
1.60 [XT03]	10142009	Finishes. High speed



X4100 SERIES

MADE IN SPAIN

VERSION PRESSURE X4100

Maximum speed, productivity and ease of application
High profitability in continuous painting

This tool gets a higher product transfer rate than conventional painting systems. It is the perfect spray gun for a high speed topcoats application. Capable to work with high paint flows. Solution for new generation paints, high solids, waterborne varnish and enamels.

VERSION	CODE	APPLICATION
1.20 [765]	10152402	Finishes and primers
1.40 [765]	10152403	Primers, basecoats
1.80 [20A]	10152406	Glues and adhesives
1.20 [XT01B]	10152409	Clearcoats and primers
1.00 [XT03]	10152406	High quality finishes. Basecoats, dyes
1.40 [3030]	10152412	Primers, basecoats. Minimum mist



VERSION SUCTION X4100

X4100 SERIES

Ideal for painting large areas, machinery and industrial vehicles
Extra deposit capacity
High speed of application

Suction system of our 4100 allows painting at right angles with the piece when painting bonnets, roofs, vehicles inside parts, trucks, chassis, trailers,...
Ideal for continuous work sessions and large surfaces. More comfortable painting and less tiredness due to the low gravity center.



VERSION	CODE	APPLICATION
1.40 [96]	10121001	High quality finishes
1.60S [96]	10121006	General finishes
1.80 [96]	10121003	Finishes and primers



3300 GTO

New 3300 GTO spraygun
High Quality. Versatile, light
Wide range of air caps, great versatility

Forged and anodized aluminum body. This is a top level product with a magnificent price-quality ratio.

Minimum maintenance. No gaskets between air and paint. High-end aluminium aircaps. High quality chromed-plating. Time and paint consumption saving.

Complying with the strictest standards on solvent emissions.

VERSION	CODE	APPLICATION
1.40 [EPA]	10141578	Finishes and dyes
1.60 [EPA]	10141579	General finishes
1.80 [EPA]	10141580	Primers
1.40 [HVLV]	10141575	Finishes and dyes
1.60 [HVLV]	10141576	General finishes
1.80 [HVLV]	10141577	Primers and basecoats

**Finish
MATTE
BODY**



Mini XTREME

Small and light, with perfect ergonomics
Perfect for retouching in vehicle production lines
Ideal for parts coating: wood, plastic and tannery products

It ensures the perfect air-paint ratio for every situation. Work with the correct fan pattern sizes without running the risk of overloading and wrong paint particle sizes. It reduces mist, saves paint and perfectly defines the work zone.

Fan patterns designed to obtain the best drying times with the finest finish, always with minimum pressures.

VERSION	CODE	APPLICATION
1.00 [miniEPA]	10111807	Retouching and feathering. Waterborne and solvent based basecoat
1.20 [miniEPA]	10111808	Clearcoats, UV paints. High finish quality
1.40 [miniHVLV]	10111805	Finishes and dyes
0.60 [miniTECH]	10111811	Primer for leather with low viscosity products
1.00 [miniTECH]	10111812	Lettering and small retouches

**VERSION
GRAVITY
XTREME**



Ideal for line-painting
Specially recommended for dyes and metallics
Top quality finishes

Due to its size it is the perfect spray gun for restricted access areas which require a lot of wrist movement.

It reduces mist, saves paint and perfectly defines the work zone.

VERSION	CODE
0.80 [miniVIT]	10111907
1.00 [miniVIT]	10111908
1.20 [miniVIT]	10111909
0.80 [miniEPA]	10111904
1.00 [miniEPA]	10111905
1.20 [miniEPA]	10111906
0.80 [miniHVLV]	10111901
1.00 [miniHVLV]	10111902
1.20 [miniHVLV]	10111903

**VERSION
PRESSURE
XTREME**



475 XTECH

**deposit
125 ml
capacity**

Reduced dimensions
Highest spray quality
125 ml. deposit capacity
Precision solutions for those small details and retouches

Ideal for feathering, small retouches, patches and/or repainting small parts.

Large variety of nozzle & needle and solutions.

VERSION	CODE	APPLICATION
0.50 [05]	20140801	Retouches and feathering. High quality
0.80 [05]	20140802	Retouches and feathering
1.00 [10]	20140803	Metallics and clearcoats. High speed
1.00 [R5]	20140804	Tiniest feathering. Max. precision



R5 Aircap



Certificate CE
Ex II 2 GX

MADE IN
SPAIN



*Full equipment (trolley and absorption), includes 4100 Xtreme Pressure spray gun 1.20 (XT01 B) and 5 m. air and product hose (ø6mm. inside).

DM 1/400

Low pressure painting equipment
High production
Several spray guns
Double membrane pump 40L

RATIO
1:1
PRESSURE

Twin Double Membrane Pump. Painting equipment for high productions. It has been designed and manufactured focusing on the needs of several trades: from small metal, plastic and wood-working factories to the highest level industrial bodyshops.

Clearcoats, dyes, clears, ceramics, and glues. Basecoats, primers and, in general, medium viscosity products.

CODE	VERSION
30920499	Full equipment*



FREE
30L/min
FLOW

DM 1/300

Pressure ratio 1:1
Medium production
High precision
Double membrane pump 30L

RATIO
1:1
PRESSURE

Twin Double Membrane Pump. Painting equipment for medium productions. Ideal for finishes and primers. High precision product regulator. Anti-pulsation system and double paint filter.

Laquers, clearcoats, basecoats, enamels,... in general, medium viscosity products.

CODE	VERSION
30920599	Full equipment*



*Full equipment (trolley and absorption), includes 4100 Xtreme Pressure spray gun 1.20 (XT01 B) and 5 m. air and product hose (ø6mm. inside).

6110 INOX

10 L. capacity
Made of stainless steel

Stainless steel body and lid. Double, high precision, robust regulators with anti-return valve. Valid for waterborne and solvent-based paints. 10 L. capacity. Hand mixer.

CODE	VERSION
10540702	6110 Inox
30920599	Full equipment*



612

Easy to use
Robust
Minimum maintenance

Pressure pot. Aluminum body and lid. 2.5 litres deposit capacity. Top outlet and pressure regulator.

Valid for waterborne and solvent-based paints.

CODE	VERSION
10540801	612 pot
10540899	Full equipment*



*Full equipment, includes 4100 Xtreme Pressure spray gun 1.20 (XT01 B) and 1.8 m. air and product hose.



Certificate CE
Ex II 2 GX

MADE IN
SPAIN

RAIDER 300

RATIO
30:1
PRESSURE

FREE
1.26 L/min
FLOW



Full equipment MIX AIRLESS

This line, exclusively designed and manufactured for professional use, gathers high standards both in term of performance and image.

Within the quality standards we focus on simplicity and durability.

Thus, we have redesigned completely the hydraulics.

Now it contributes to a long-lasting life even in the worst working conditions and without waiving on its performance.

CODE	VERSION
30951698	Full MIX equipment*
30951699	Full AIRLESS equipment**



MACK 150

RATIO
15:1
PRESSURE

Full equipment MIX AIRLESS

High production. Ideal for high quality finishes, easy to use and highly robust.

Reduced system maintenance and self-adjusting packing.

Varnishes and waterborne paints, lacquers, basecoats and primers, enamels and antioxidants.

CODE	VERSION
30931999	Full MIX equipment*

FREE
1.8 L/min
FLOW

*The full MIX equipments (trolley and absorption), includes Mini Xtreme Mix spray gun and 5 m. air and product hose. (see images)



**The full AIRLESS equipments (trolley and absorption), includes PSAM 104 airless spray gun, swivel cap, swivel head and 10 m. product hose (security).



TROLLEY AND DEPOSIT OPTION

CONSULT



MACK 320

RATIO
32:1
PRESSURE

FREE
2.7 L/min
FLOW

Full equipment MIX AIRLESS

Pneumatic pump for high speed and production. Easy to use and highly robust.

Reduced maintenance and self-adjusting packing system.

Clearcoats, lacquers, fillers, primers, enamels, antioxidants, synthetic paints. Suitable for waterbase products.

CODE	VERSION
30932099	Full MIX equipment*
30932098	Full AIRLESS equipment**



Certificate CE

Ex II 2 GX

MADE IN
SPAIN

MACK 400

RATIO
40:1
PRESSURE

Full equipment **MIX** ✗ **AIRLESS** ✓

High production Airless pump. Tungsten Carbide valves. Enamels (polyurethanes, epoxys), anti-corrosive primers, intermediate layers and thick, chlorinated rubber, bituminous, mold release,...

Valid for water-based product applications.

CODE	VERSION
30932299	Full AIRLESS equipment*



FREE
7.2 L/min
FLOW



*Full equipment, includes PSAM 107 airless spray gun, wivel cap, swivel head and 10 m. product hose (security).

HTV 250

RATIO
25:1
PRESSURE

Full equipment **MIX** ✓ **AIRLESS** ✗

Designed and manufactured for professional use, the HTV 250 offers excellent performance both in terms of features and design.

The hydraulic components were redesigned for highest level of quality focused on technology and durability. The bellows system provides long-lasting durability with minimum maintenance even for highly demanding materials.

Clearcoats and waterborne paints, lacquers, enamels, fonds, light primers,...

VERTICAL BELLOWS

NEW BELLOWS system.
Completely eliminates packing gland leaks. Multiplies X5 the life of your conventional equipment. It requires no lubrication in the shaft area.

CODE	VERSION
30932299	Full MIX equipment*

*Full equipment, (trolley and absorption), includes Mini Xtreme Mix spray gun and 5 m. air and product hose.



FREE
2.8 L/min
FLOW



ATLANTA 800

ELECTRIC AIRLESS

Full equipment

CODE	VERSION
30940999	Full equipment*

Maximum production. Airless electric diaphragm pump. Powerful and robust for continuous tasks with 1 or 2 spray guns. Application of plastic paints, primers, varnishes, water-proof, fireproof, bituminous, epoxies, chlorinated rubber,....

*Full equipment, includes PSAM 107 airless spray gun, wivel cap, swivel head and 10 m. product hose (dispersions).



ATLANTA 200

ELECTRIC
AIRLESS

Full equipment

CODE*
30941299

Medium production. High-quality paints. Application of clearcoats, undercoats, primers, enamels and varnishes. In general, medium viscosity products.

*Full equipment, includes PSAM 104 spray gun, wivel cap, swivel head and 10 m. product hose (dispersions).



ATLANTA 500

ELECTRIC
AIRLESS

Full equipment

CODE*
30940899

High production. Airless electric membrane pump for the application of plastic paints, primers, varnishes, chlorinated rubber, waterproof.

*Full equipment, includes PSAM 104 spray gun, wivel cap, swivel head and 10 m. product hose (dispersions).



MIX
Spray gun
200 bar

Mini XTREME MIX

**Functionality, performance
and reduced size
Ideal for complex jobs**

A perfect combination of speed and high transfer levels (above 80%) with XTREME systems quality finishes. Designed for durability in time due to its robustness and quality of its components.



VERSION	CODE
11/40	35130201
13/40	35130205

PSAM 107

**Pressure: up to 450 bar
Extremely robust and
durable**

For professional use with an anodised aluminium body and comfortable action due to its four-finger trigger.

All the advantages of the airless system: speed, high thickness and minimum overspray.

It is recommended for using with all types of low, medium and high viscosity products.



CODE
30170101

4100 XTREME CERAMIC

**Nozzle and Needle in
Tungsten Carbide
Ideal for high microns jobs
and highly abrasive products**

High transfer level. In the ceramic applications, we provide the maximum resistance. And in vitroceraamic, we can achieve the highest degree of refinement and finishing quality.



VERSION	CODE
1.4 [78]	10152130
1.4 [XT03]	10152131
1.8 [67]	10152132
2.2 [64]	10152133
2.8 [62]	10152135



4100 XTREME PD

**Ideal for difficult jobs
Speed of application and
high transfer level**

Ideal for marking paints, road markings, primers, high thickness, waterproofing, intumescent, soil protection, generally dense products,...



VERSION	CODE
6.0 [PD1]	10152301

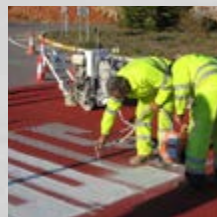

TURBO3000 PRO

**3-stage turbine
High performance
Maximum quality**

Autonomous Turbine Equipment for the application of dyes, lacquers, enamels, clearcoats, primers, textured products and cast iron effect.

Ideal for painting and assemblies works.

Metallic spray gun with fan and product regulators. Deposit with anti-return valve, flange closure and anti-drip lid.

**POWER
1,400
WW**

CODE
30640201



NEW
21 EPA
AIRCAP

Classic Pro XD

Professional gravity spray gun

The best price/quality ratio in conventional primer spray guns. Low air consumption. Robustness and reliability. New high strength chrome body. Maximum ergonomics and comfort. Nozzles and needles in Stainless steel.

VERSION	CODE	VERSION	CODE
1.40 [21 EPA]	10141620	1.40 [HVLP]	10141621
1.60 [21 EPA]	10141623	1.60 [HVLP]	10141624
1.80 [21 EPA]	10141625	1.80 [HVLP]	10141626
2.00 [25]	10141627	2.50 [HVLP]	10141631
2.50 [36]	10141629		
2.80 [28]	10141630		



Classic Lux

Economical gravity spray gun

Conventional painting system with very low air consumption. New body. Maximum ergonomics. Light and versatile. High reliability. Air, paint and air flow regulators. Gravity deposit with anti-drip system.

VERSION	CODE
1.40 [40]	20141406
1.60 [40]	20141401
1.80 [40]	20141402
2.00 [41]	20141404
2.50 [42]	20141403



Classic Pro

Suction version

High capacity deposit (1 liter). Light injected aluminium body. Single spindle design means fewer parts. Regulators in aluminum. Stainless steel nozzle and needle. One-piece packing nut. There are no O-rings.

VERSION	CODE
1.60 [21]	10120701
1.80 [21]	10120702

deposit
1 liter
capacity



Classic Lux

Suction version

High capacity deposit (1 liter). Economical gravity spray gun. Conventional painting system with very low air consumption. Light and versatile. High reliability. Air, paint and air flow regulators. Fastening with flange, anti-drip lid and closure gasket.

VERSION	CODE
1.60 [38]	20121101
1.80 [38]	20121102

deposit
1 liter
capacity



Junior G

Economical gravity spray gun

Light and economical gravity spray gun with air valve, high transfer and very low air consumption. New matt chrome body. Robust, light and with new ergonomic design proper to work with 1.5 HP compressors. Product and fan regulators. Blister or box presentation.

deposit
600 ml
capacity



Blister

ALTA TRASPARENZA
65%
HIGH TRANSFER

VERSION	CODE	APPLICATION
1.40 [box]	20141904	Finishes
1.60 [box]	20141903	Finishes and primers
1.80 [box]	20141902	Primers and basecoats
1.80 [blister]	20141905	Primers and basecoats



CODE
20160103

Super Kit

Paint professional kit

Professional paint spray gun with stainless steel nozzle Classic Lux 1.80 [21]. Petroleum spray cleaner with 1L deposit, Clasic P1. Highly accurate and durable inflator Classic I and blowgun Classic S1. Metallic aircaps in P1 and S1.



Includes quick connector

TURBO 1000

**POWER
1,000
WW**

CODE
40000318



Professional HVLP autonomous tool. Minimum mist. Turbine unit valid for all types of paints, finishes, primers, multi-colours (includes two nozzle combinations as standard equipment). Gun holder, cable reel and accessory holder. Includes removable air filter.

610

Full equipment

Steel body and aluminium lid. Top outlet. Valid for solvent-based paints.

Low and medium viscosity paints.

**deposit
10 liters
capacity**



CODE	VERSION
40000273	612 Pot
10540798	Full equipment*

Premium 429N

**deposit
5 liters
capacity**

Stone paints, gotele and viscous products
With air inlet shut-off valve
Product anti-pack system

Product and air-flow regulators.

High quality 5L paint deposit with handle and removable lid for cleaning.

Includes 4.5, 6 and 8 mm aircaps.

Trigger lock system for ease of continuous use.

Non-stick coating in the body of the spray gun for ease of cleaning.

Air consumption: 170 L/min. at 3.5 bar.

CODE
10140201



Classic XD Smooth

Plastic paints or multicoloured
5 liters capacity deposit

Spray gun with 5L deposit and handle. Ideal for the application of viscous products frequently used in decoration, such as plastics or multicoloured.

Non-stick coating in the body in order to make cleaning easier.

VERSION	CODE	APPLICATION
2.00 [25]	10141640	Multi-colours, plastics
2.50 [25]	10141641	Multi-colours



3300 GTO

Pressure spraygun

Application of enamels, varnishes, primers and basecoats. High performance and atomization. High transfer aluminium aircaps. Large size fan. High speed application. Versatile.

VERSION	CODE
1.00 [HVLP]	10152201
1.20 [HVLP]	10152202
1.40 [HVLP]	10152203
1.00 [EPA]	10152204
1.20 [EPA]	10152205
1.40 [EPA]	10152206



Classic 30 Inox

Full equipment
Gotele spray gun

30 L. pressure pot. (two bags of 25 kg. of paste). With handlebar, foldable for transport. Handle grip.

The gun incorporates product coupling for flange and for 3/4" thread. Stainless steel fluid nozzle and needle.

VERSION	CODE
2.80	20150901
3.20	20150902
Full Eq.	20530702



4220 PLUS

AIR
1,700 L/min
FLOW

Effective solution for compressed air filtration in professional paint booths

Two stage air filter (Coalescent filter). Maximum filtering level. Recommended for last generation finishes. Highly reliable air regulation system. Manufactured from a solid aluminum block. Waterborne paints, HS clearcoats and enamels, high gloss lacquers,...

CODE
10750402



479 PLUS

The most compact solution for the small workshops

Large air flow, highly reliable regulating system, high quality pressure gauge, the best materials. Produced from a solid aluminium block, great filtration capacity with check window for waste particle and semi-automatic drain system, it has everything in a minimum space.

VERSION	CODE
1/2"	10730401
3/8"	10730402
1/4"	10730403



5000X

Valid for highest quality finishes

Air purifying filter with pressure regulator and pressure gauge. Its NEW VESSEL is tougher and more protective. The 5000X model incorporates a semi-automatic draining system. Minimum pressure loss. Double outlet.

AIR
2,500 L/min
FLOW

CODE
10730204



970 PLUS

Max. working
10 Bar
pressure

Assure the supply of clean and properly lubricated air to tools and pneumatic engines

The virtues of the regulator-filter 479 is now united to a lubricating element, setting itself apart as specific workshop equipment. It supplies clean, lubricated air to all your tools. Accurate control of the oil content by means of a "drop-by-drop" hand regulator, zero pressure loss thanks to the in-line design, maximum reliability and productivity in the most compact package.

VERSION	CODE
1/2"	10750301
3/8"	10750302
1/4"	10750303



The New range of plugs SAGOLA

Cutting-edge design

News: Ultralight - Security - Multi-profil

Guaranteed life of more than 1,500,000 uses

Plug body made of treated steel and valve made of brass

The new range of plugs SAGOLA incorporates a handle made of composite, which gives a high resistance to both attrition and drag. Attrition resistance tested in more than 48,000 impacts and the equivalent to a crawl 12 km.

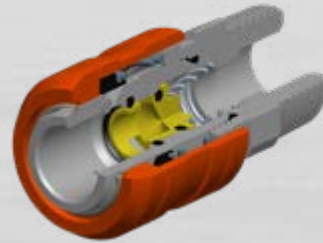

ULTRA-LIGHT range (US-MIL)

Aluminum quick coupling. The lightest in the market. Weight reduction for the tool (spray gun, sander, ...) Ultra-lightweight. 45 g. Flow: 68 m³/h. - 1,133 L/min. Body and shooter made of high strength aluminum. Valve made of brass. Pins made of high strength steel. Air coupling: 1/4"

UNITS	VERSION	CODE
1 u.	male BSPT 1/4" US-MIL	11010531
1 u.	female BSPP 1/4" US-MIL	11010431
1 u.	barb. 8mm. US-MIL	11010629



MULTI-PROFIL range

Steel quick coupling. Compatibility with the most used profiles in the market: US-Mil, Euro-Profile and Italian Profile.



UNITS	VERSION	CODE
1 u.	male BSPT 1/4" Multi-Profil	11010826
1 u.	male BSPT 3/8" Multi-Profil	11010827
1 u.	female BSPP 1/4" Multi-Profil	11010726
1 u.	female BSPP 3/8" Multi-Profil	11010727
1 u.	barb. 8mm. US-MIL	11010625
1 u.	barb. 10mm. US-MIL	11010626

MULTI-PROFIL range (security)

Steel quick coupling. Plug with gasket made of Nitrile Butadiene and double effect opening. Anti-whiplash safety plug according to ISO-4414. Two movements "push-pull" to disconnect.

High strength sleeve. Compatibility with the most used profiles in the market: US-Mil, Euro-Profile and Italian Profile.

UNITS	VERSION	CODE
1 u.	male BSPT 1/4" US-MIL	11010528
1 u.	male BSPT 3/8" US-MIL	11010529
1 u.	male BSPT 1/2" US-MIL	11010530
1 u.	female BSPP 1/4" US-MIL	11010428
1 u.	female BSPP 3/8" US-MIL	11010429
1 u.	female BSPP 1/2" US-MIL	11010430
1 u.	barb. 8mm. US-MIL	11010627
1 u.	barb. 10mm. US-MIL	11010628



Workshop **ACCESSORIES**

\$25

Solvent washer

Compact machine of small size. Designed to automatically clean spray guns and painting accessories when working with solvent-based paints and clearcoats. Capacity for 2 guns, 2 cups and lids.



CODE
40000521

COMPACT 235

Solvent washer

For automatic cleaning, manual with brush and automatic final cycle of clean solvent. Recirculation solvent automatic cycle (timer). Auto-extraction of solvent vapors.



CODE
40000522

CLASSIC 51

Blowguns

Light and robust. Made of aluminium.



VERSION	CODE
Plastic aircap	20340604
Metallic aircap	20340601
Extension aircap	20340603
Venturi system	20340605

3900 PLUS

Pneumatic sealers

Efficient and light solution for everyday needs in any workshop. These pneumatic guns are very useful when it comes to restructure assembling, repairs and windshield set-ups, amongst others.

VERSION	CODE
3900 PLUS	10330201
3900 PLUS M4	10330401
3900 PLUS M6	10330402

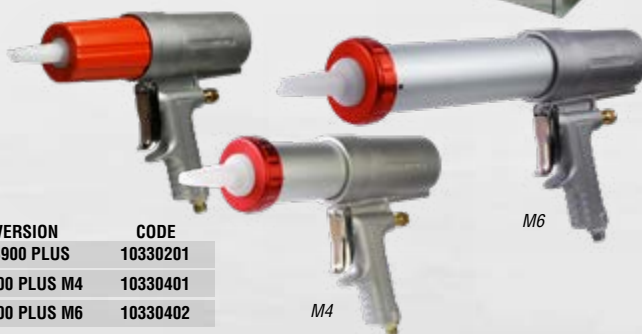

518 PLUS

Pressurized pneumatic gun for antigravel cartridges and underbody protection

Total regulation on product flow and quality atomization and spray size. Operating pressure.

CODE
10330301



L Range Pneumatic sanders

L range sanders have been designed for workshops where high performance and top quality finishes are demanded.

VERSION	CODE	APPLICATION
L 505	40000232	Grinding and fast sanding
L 252	40000231	High quality finishes
L 252R	40000230	Fine finishes

L505

L252

L252R



4240

Full breathing equipment

It includes: belt, pocket regulator and coalescent filter to remove low levels of moisture and oil. 10 meters of hose and safety plugs, 1.5 meters of hose spray gun outlet.

CODE
15830101

MP300

Breathing mask

Mask with double charcoal filter against organic and solvent fumes. Facial housing of thermoplastic rubber. Elastic tape fastener.

Approved:
EN 141
EN 140
UE 2016/425

CODE
14810301



CODE
40000086

Cleaning kit

Complete cleaning set, including one brush for outside cleaning, and rods of different sizes for all the inner paths of the spray gun. Supplied in a practical show.



CODE
56418589

Lubricant grease

Natural grease, specially made of spray guns and painting equipments moving parts lubrication. High consistency, even under extreme temperatures. Long lasting, it doesn't lose properties over the time. Easy to open 100 ml. can.

Manufacturing...

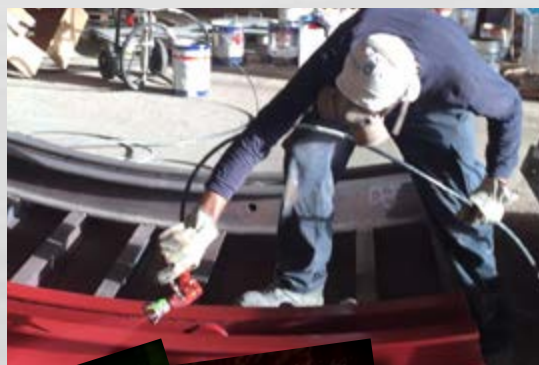
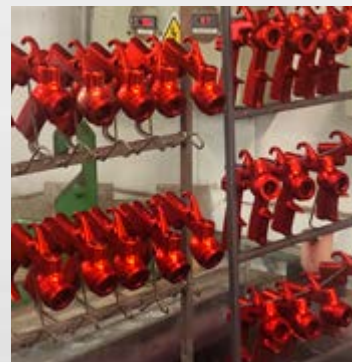

**Download our catalogues at
www.sagola.com**

Find more details and products
in our website.



SAGOLA [®]
an Elcometer company

SAGOLA S.A.U.

Urartea, 6 · 01010

Vitoria-Gasteiz (Álava) SPAIN

Tel.: (+34) 945 214 150

Fax: (+34) 945 214 147

sagola@sagola.com

www.sagola.com



**MADE IN
SPAIN**

